

BT-52П

NO.	DESCRIPTION	NO.	DESCRIPTION	NO.	DESCRIPTION
1	GEAR CASE ASSY	33	SCREW M5X20	65	SCREW M5X30
2	STOP RING	34	NUT M5	66	CABLE COMP
3	STOP RING	35	CLUTCH COMP	67	TUBE
4	BEARING 6000Z	36	CLUTCH DRUM COMP	68	STOP BUTTON COMP
5	PINION	37	STOP RING	69	HAND GRIP
6	STEEL PLATE	38	BEARING 6202	70	SPRING
7	CAPSCREW M5X20	39	STOP RING	71	BOX LEFT
8	WASHER	40	UNKER	72	NYLON CUTTER HAND
9	SCREW M5X12	41	RUBBER COVER	73	CASE
10	BOLT M6X12	42	SCREW M5X20	74	LEFT NUT
11	WASHER	43	SCREW M5X12	75	WASHER
12	GEAR CASE	44	STOP RING	76	SPRING
13	BLADE COVER	46	CLAMP	77	NYLON CORD
14	BEARING 6000Z	47	WIRE CLAMP BAND	78	CORD HOLDER
15	GEAR	48	HARNESS ASSY	79	PLATEN
16	SHAFT	49	BOLT M5X25	80	COVER
17	BEARING6002	50	CAPLOWER	81	BRACKET
18	STOP RING	51	BRACKET	82	SCREW M5X30
19	HOLDER	52	HANDLE	83	SAFETY GUARD
20	HOLDER	53	GRIP LEFT	84	WASHER
21	HOLDER	54	CAP OPPER	85	SCREW M5X16
22	LEFT NUT	55	HANDLE	87	GUARD
24	BLADE	56	LEVER ASSY	88	BLADE
25	PIPE COMP	57	SCREW ST2.9X13	89	GUARD ASSY
26	RUBBER COVER	58	BUTTON	92	M5X15 BOLT
27	OIL BEARING	59	SPRING	93	HANDLE HOLDER (COVER)
28	DRIVE SHAFT	60	CLOCK PIN	94	M5X35 BOLT
29	PIPE	61	HAND GRIP	95	THUMB SCREW
30	HOLDER ASSY	62	SPRING	96	NUT
31	HARNESS CLAMP	63	BOX RIGHT		
32	CLAMP	64	SCREW ST2.9X18		

BT-52П-ex-20201103

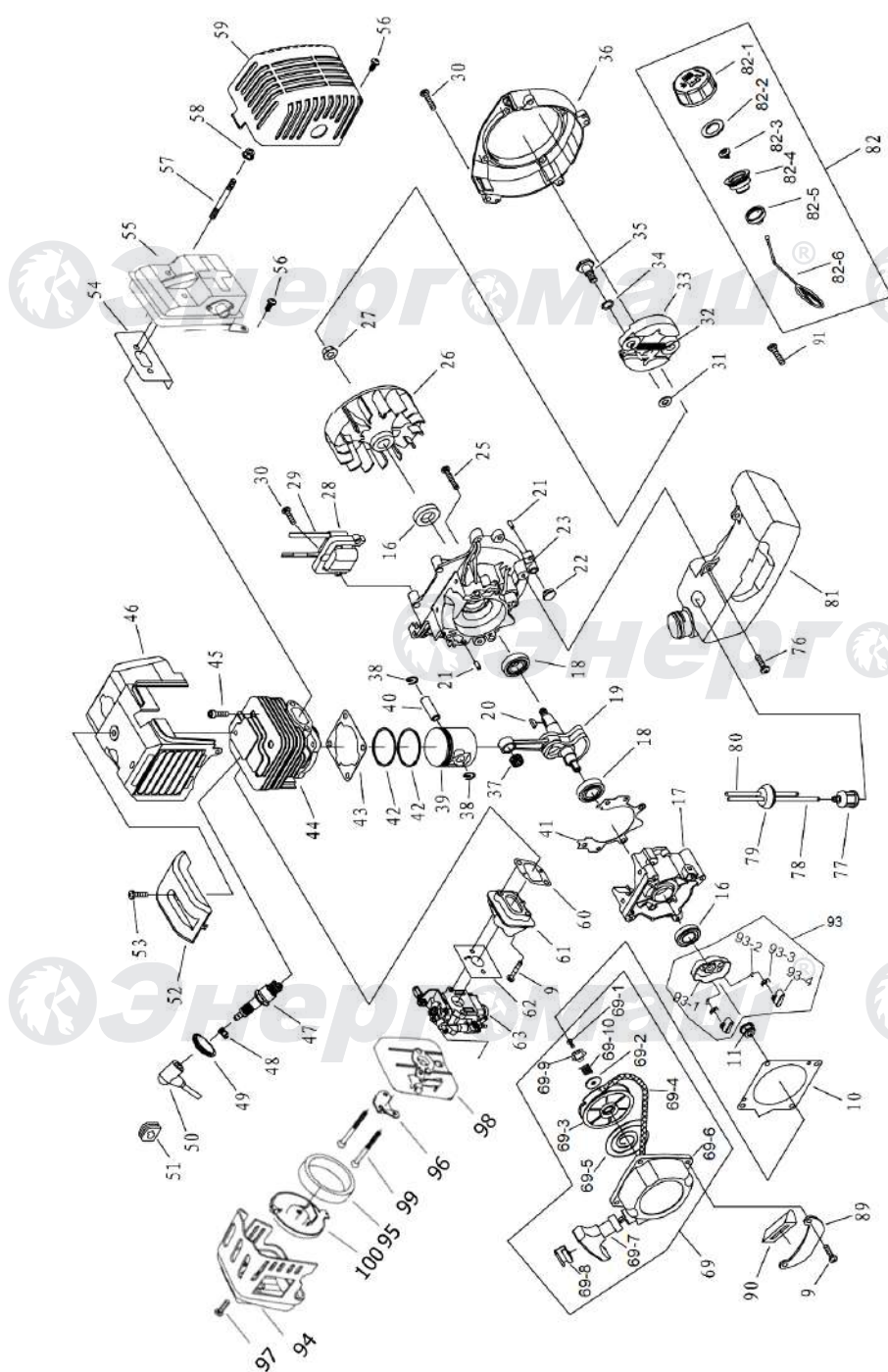

ЭЛЕКТРОДВИГАТЕЛЬ ДЛЯ БТ-52П

NO.	DESCRIPTION	NO.	DESCRIPTION	NO.	DESCRIPTION
9	SCREW M5X20	44	CYLINDER	69-10	EASY START COIL SPRING
10	GASKET	45	SCREW	76	SCREW M5X16
11	NUT	46	GUIDE COVER ASSY	77	CLEANER COVER
16	OIL SEAL	47	SPARK PLUG	78	OUTLET FUEL PIPE
17	CRANK CASE	48	SPRING	79	PLUG
18	BEARING 6202	49	PLUG COVER	80	INLET FUEL PIPE
19	CRANKSHAFT	50	PLUG CAP	81	FUEL TANK
20	KEY	51	PLUG	82	LID ASSY
21	PIN	52	UPPER COVER	82-1	FUEL TANK LID
22	RUBBER WASHER	53	SCREW	82-2	GASKET
23	CRANK CASE	54	GASKET	82-3	INLET
25	SCREW M5X30	55	MUFFLER	82-4	INSIDE COVER
26	MAGNETO ROTOR COMP	56	SCREW	82-5	LID
27	NUT	57	BOLT	82-6	CHAIN
28	IGNITION COLL COMP	58	NUT	89	STAND
29	CORD COMP	59	MUFFLER COVER	90	RUBBER COVER
30	BOLT M5X20	60	GASKET	91	SCREW M5X20
31	WASHER	61	ADMITTING PIPE	93	STARTER PULLEY ASSY
32	SPRING	62	GASKET	93-1	STARTER REEL
33	EXPANDER	63	CARBURETOR	93-2	STOP RING
34	WASHER	69	STARTER	93-3	STARTER PAWL SPRING
35	SCREW PIN	69-1	SCREW	93-4	STARTER PAWL
36	FAN COVER	69-2	WASHER	94	AIRFILTER COVER
37	BEARING 10X14X16	69-3	START POPE REEL	95	AIR CLEANER
38	RING	69-4	POPE	96	AIRFILTER COVER SEAT
39	PISTON	69-5	RECOIL SPRING	97	SCREW
40	PISTON PIN	69-6	START COVER ASSY	98	CHOKE SEAT ASSY
41	GASKET	69-7	START HANDLE	99	SCREW
42	PISTON RING	69-8	RING	100	CIRCULAR COVER
43	GASKET	69-9	START RATCHET		

БТ-52П-ex-20201103